



As a member of the well-known hotel collection „The Leading Hotels of The World“, the Hotel Königshof celebrates luxury in the grand hotel still with classic elegance and a royal ambience. The unique panoramic view over the Karlsplatz / Stachus and the Michelin star-awarded Gourmet Restaurant are experiences not to be missed.

LOCATION

Karlsplatz 25 | 80335 Munich

Directly at the Karlsplatz/Stachus

Distances:

Central railway station: 200 m, Airport (direct connection): 35 km,

Messe München exhibition centre (direct connection): 13 km

CONTACT

Event Sales

☎ +49 89 55 137 8140 | 📠 +49 89 55 137 8174

✉ bankett@geisel-privathotels.de | 🌐 www.koenigshof-hotel.de

ROOMS

87 rooms

23 Superior rooms (25 m²), 48 Deluxe rooms (35 m²) 8 Junior suites (40 m²), 8 suites (60 m²)

Some rooms offer a view over the Karlsplatz / Stachus square or the Palace of Justice.

Facilities: Air conditioning, sound-proof windows, mini bar, safe, Nespresso coffee machine, free Wi-Fi and SKY TV, two complimentary bottles of mineral water per day, ETRO brand care range

WELLNESS

Sauna, steam bath, whirlpool, fitness room, rest area

PARKING

180 underground parking spaces with video surveillance, EUR 25 per day, valet parking service

SERVICE / HOTEL FACILITIES

24-hour room service, breakfast buffet, air-conditioned hotel, two lifts, laundry, dry cleaning, wake-up service, 24-hour reception service, multilingual staff, turndown service, free Wi-Fi, concierge service, limousine service, 1 complimentary bottle of mineral water upon check-out, "Geisels Weingalerie" wine boutique with over 600 different wines from various growing areas

RESTAURANT & BAR

Gourmet Restaurant Königshof

- Awarded with 1 Michelin star and 18 points out of 20 in the Gault Millau guide
- Chef de cuisine: Martin Fauster
- Panoramic view over the Karlsplatz / Stachus
- Seasonal, classic cuisine with a French influence
- A wide selection of exclusive, classic wines from German and international growing areas
- Ideally suited for first-class private dining events

Königshof Bar

- Open daily from 09:00-01:00, with live piano or jazz music (every Friday and Saturday) and an exclusive ambience
- One of the largest whisky and wine selection in Munich
- ☐ Can be booked exclusively

CONFERENCE ROOMS

- 3 conference rooms, individually combinable for up to 90 people
- All rooms offer natural daylight
- 115 m² of event space
- First-class catering from the Gourmet Restaurant Königshof
- All event rooms are on the same floor and in the immediate vicinity of the Gourmet Restaurant
- Free Wi-Fi
- Air-conditioned

CONFERENCE PACKAGE

from EUR 89 per person

- Conference room according to number of people
- Wi-Fi
- Projector, screen, flip chart (unlimited paper) or pinboard
- Pens and pads
- Welcome coffee
- Unlimited mineral water for the duration of the conference
- Two-course lunch menu in our Königshof Gourmet Restaurant
- Unlimited mineral water during lunch
- 1 hot drink after lunch
- 2 coffee breaks with seasonal snacks

BOOKING CONDITIONS

Valid upon request and availability for events, with a minimum of 10 participants. All prices indicated include VAT.

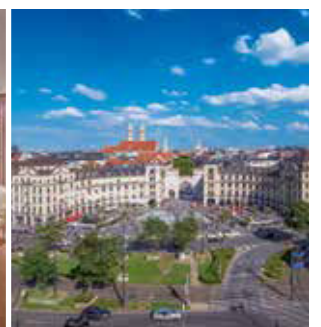

EVENT ROOMS

PROFESSIONAL MEETINGS AND ELEGANT EVENTS

GEISEL
PRIVATHOTELS
SEIT 1900

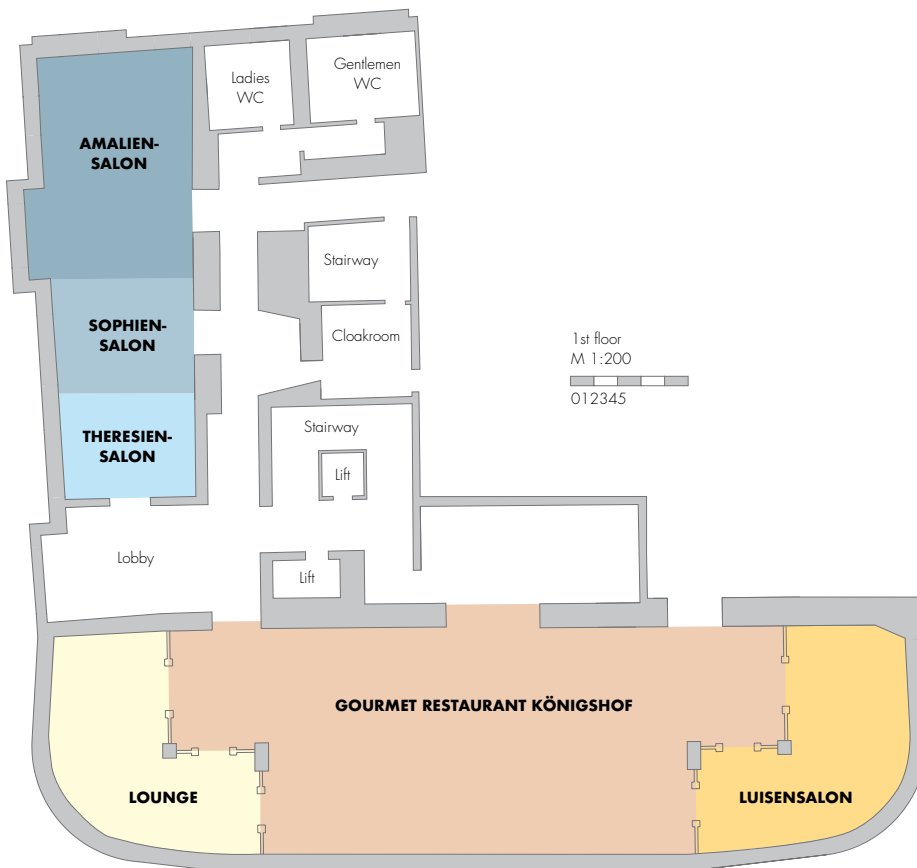

LEGEND

- U-Shape (outside seating)
- Block
- Parliament
- Theatre-style
- Banquet (round/oval tables)
- Standing reception
- Floor area in m²
- max. room length (L),
-width (W),
-height (H) in m
- Daylight
- Room suitability
(D = Dinner,
REC = Reception,
L = Lunch,
M = Meeting)

ROOM										
Amaliensalon	25	24	25	40	24-40	40	60 m ²	9.00 L x 6.75 W x	✓	D · L · M
Sophiensalon	–	12	–	–	–	15	30 m ²	5.00 L x 6.00 W x	✓	M
Theresiensalon	–	10	–	–	–	10	25 m ²	4.50 L x 5.50 W x	✓	M
Amaliensalon & Sophiensalon	40	40	40	70	60	70	90 m ²	14.0 L x 6.75 W x	✓	D · L · M
Sophiensalon & Theresiensalon	20	24	20	35	24-40	35	55 m ²	9.50 L x 6.00 W x	✓	D · L · M
Königshofsalons (Amalien-, Sophien- and Theresiensalon)	50	50	50	90	80	90	115 m ²	18.50 L x 6.75 W x	✓	D · REC · L · M
Gourmet Restaurant Königshof	–	–	–	–	160	–	189 m ²	21.00 L x 9.00 W x	✓	D · L
Lounge	–	22	–	–	36	40	43 m ²	9.60 L x 4.50 W x 2.75 H	✓	D · REC · L
Luisensalon	–	22	–	–	36	40	43 m ²	9.60 L x 4.50 W x 2.75 H	✓	D · REC · L